

SELECTIONS FROM DR. EDWARD N. TIHEN'S NOTES FROM WICHITA NEWSPAPERS
COPY PROVIDED BY SPECIAL COLLECTIONS, WICHITA STATE UNIVERSITY

Please note: The "Tihen Notes," as we call them, provide an excellent starting point for further research. They present brief synopses of newspaper articles, identify the newspaper -- Eagle or Beacon -- in which the stories first appeared, and give exact references to the pages on which the articles are found. Microfilmed copies of these newspapers are available at the Wichita State University Library, the Wichita Public Library, or by interlibrary loan from the Kansas State Historical Society.

Keywords: Stackman

Wichita Eagle

Saturday, March 28, 1891

page

5. Article reports death of Fred Stackman yesterday. He leaves a large and valuable property.

Wednesday, May 29, 1901

page

6. City buys four acres for \$1,200 adjacent to Little river from Mr. Steinbuchel, representing the Stackman heirs—see comment from Mr. Steinbuchel on May 30, 1901, page 5.

Tuesday, January 6, 1903

page

5. Reports of city officers given to city council yesterday for the past nine months. ¶ Police department now consists of a total of 21 persons. ¶ Fire department has four stations: Number 1 - on North Market between 1st and 2nd; Number 2 - on South Topeka between William and English; Number 3 - at corner of 18th and Topeka; and Number 4 - on Seneca near Douglas. ¶ Park commissioners report: ¶ Since our last report we have completed the large arch at the Murdock avenue entrance of Riverside park. The top of the arch has been covered by a good shingle and tin roof and the sides and ends by a veneering of brick, which makes a good substantial structure. ¶ The driveways in the park have benefitted by ten loads of crushed rock either donated or to be donated by each of the four railroads. ¶ We have also established a small zoo in the park. ¶ An artificial lily pond was built in North Riverside park last spring. ¶ The new park north of 15th street has been named McKinley park. ¶ Street commissioners report that a large force of men was employed during the winter to remove the Davis Island in the Big Arkansas at Maple street, and the Stackman Island in the Little Arkansas river.

Tuesday, July 22, 1913

page

2. City commission seeking an injunction suit to stop the Wichita Water company from taking water from the Little Arkansas river near the Central avenue dam. The city claims it owns both banks of the Little river above the dam. ¶ The Water company contends that

the city has no title to any land where the company is getting water and that the company owns the water to the center of the river, assuming that the intake of the water pipe is on the banks of the Little Arkansas river. ¶ However the Water Company also contends that the government survey shows that the pipe is some distance below the mouth of the Little Arkansas. The pipe and the Central avenue dam are actually on the Big Arkansas river they contend. From the mouth of the Little river just south of Pine street, the water runs through the north channel of the Big Arkansas river, which extends between Stackman's farm and Water Works Island. The north channel has been dry for a number of years, but nevertheless it is the channel of the Big Arkansas river. The Big river is a government stream and the city has no authority over it they say.

Sunday, June 13, 1920

page

15. Advertisement and diagrammatic map announce opening of Stackman addition.

Saturday, September 3, 1921

page

3. Herman J. Steinbuchel, pioneer resident of Wichita, died yesterday at his residence, 1017 Franklin avenue, at age 77. Came to Wichita in 1874. Survivors are widow, Marie, one daughter, Mrs. W. B. Wilson, two sons, Herman J., Jr. and Max, one step-daughter, Mrs. Bertha Stackman Gouldner, and three sisters and two brothers. Photograph.

Saturday, September 4, 1926

page

2. Article says city is to complete purchase today of 7.15 acres at intersection of Sim Park Drive and River Boulevard as site for a municipal art museum. The site is being sold by Mrs. Marie Steinbuchel, administratrix for the Stackman estate, for \$16,500. ¶ Mrs. Bertha Stackman Gouldner, another of the Stackman estate heirs, said the estate would sell any part of the remaining 21 acres in the tract to the school board for a school site, at approximately the same price. Details.

Sunday, June 3, 1928

page

4. An eight apartment building is to be erected at Gilman and Franklin aves. in next 90 days by Fred C. Stackman at cost of \$45,000.

Saturday, August 25, 1928

page

2. Building permits issued yesterday to Fred Stackman for \$20,000 apartment house at 1207 Franklin.

Tuesday, July 21, 1931

page

2. City commission yesterday voted to name the new Central avenue bridge for Frederick P. Stackman, father of Mrs. Rene Gouldner. He died 34 years ago at age 46 but had already

amassed considerable holdings in Wichita real estate. Mrs. Gouldner was then but a child and remembers that the Little river was just a small creek, and the cattle feeding ground was on the site of the municipal pool. The Stackman farm of 130 acres in Riverside purchased by her father in 1882 was then "out in the country." Mr. Stackman moved to Wichita in 1873 from Topeka. Details.

Friday, October 2, 1931

page

5. The new Stackman bridge over Little river on Central was opened to traffic last evening. Cost was about \$75,000.

Sunday, October 29, 1939

page

5. Work is to start this week on laying of the 48 inch pipe line from equus beds to city. Excavation started Friday for the new filtration plant on the Stackman tract on north side of Sim park drive immediately east of Sim park and west of the art museum. The new 3,000,000 gallon reservoir will be at the east end of the newly acquired tract, immediately west of the art museum.

Thursday, January 2, 1947

page

5. Report of death yesterday of Mrs. Marie Steinbuchel, 80, Wichita pioneer and widow of Herman Steinbuchel. Born in Strasbourg, France in 1866 and came to the United States in 1887 as the bride of Fred P. Stackman. She was married to Herman Steinbuchel in 1892. Her children included Mrs. R. M. Gouldner, Fred C. Stackman, Herman J. Steinbuchel, Max Steinbuchel, and Mrs. Elizabeth Wilson Gouldner. Eight grandchildren and one great grandchild are named -- all but one in Wichita. Lived at Stackman Courts, 1207 Franklin. Further biography. Photo.

Thursday, October 16, 1947

page

5. Building permit issued yesterday to Max Steinbuchel, for an apartment house at 1326 Stackman Drive, to be a two story brick building with full basement and contain 28 dwelling units, and to cost \$60,000. John Niebaum is the architect. Building permit also taken out to build a basement next door at 1320 Stackman Drive, to be 43 by 137 feet, the same size as that in the above apartment house, and to cost \$2000.

Sunday, July 25, 1948

page

Special 76th anniversary edition of the Eagle with special articles, etc.

- 10A. Photo of new apartment buildings under construction on Stackman Drive by Max Steinbuchel. To be known as Riviera Plaza, cost \$125,000, to be completed in December.

Wednesday, August 22, 1962

page

- 5A. City commission yesterday voted to approve construction of two new wings on the Wichita Art Museum building, 619 Stackman Drive. Museum directors will be asked to recommend an architect. Estimated cost is \$150,000. Details.

Sunday, October 6, 1963

page

- 4A. Ribbon cutting ceremony at noon today will open the two new wings of the Wichita Art Museum, 619 Stackman Drive. Details.

Sunday, September 3, 1967

page

- 6B. Announcement of plans for building the S. G. Riviera garden apartment complex at 705-715 Stackman Drive. To have 48 units. Robert A. Aylward is owner and developer. Site was the home of Frederick P. Stackman who owned 130 acres of the surrounding land and reared his family there in a house, razed last spring, which he built in the 1870s. Architects are Feagins and Kirsch. Details. Construction to start about September 15 with first units ready for occupancy by April 1. Rents will range from \$225 to \$350 a month. Drawing.

SELECTIONS FROM DR. EDWARD N. TIHEN'S NOTES FROM WICHITA NEWSPAPERS
COPY PROVIDED BY SPECIAL COLLECTIONS, WICHITA STATE UNIVERSITY

Please note: The "Tihen Notes," as we call them, provide an excellent starting point for further research. They present brief synopses of newspaper articles, identify the newspaper -- Eagle or Beacon -- in which the stories first appeared, and give exact references to the pages on which the articles are found. Microfilmed copies of these newspapers are available at the Wichita State University Library, the Wichita Public Library, or by interlibrary loan from the Kansas State Historical Society.

Keywords: Stackman

Wichita Beacon

Thursday, July 21, 1898

page

5. Long article reporting court hearing of Mrs. Steinbuchel's injunction suit against the city to prevent building of the Central avenue dam on grounds it would flood some of the Steinbuchel (formerly Stackman) land and damage her property and cause loss to her heirs. Details.

Thursday, April 20, 1899

page

6. Article says the only remaining eyesore in the South Riverside park area is the old river bed on the west side of the river, claimed by the Stackman heirs. The city has never been able to get Mr. Steinbuchel's consent to clean up that part of the river.

Monday, May 1, 1899

page

5. Article about the low land on the old Stackman farm on the west side of the Little river from South Riverside park. It was at one time the river bed and several acres of it are grown up in trees. It has always overflowed during high water, but since the dam has been built the water covers the low ground all the time. Discussion as to what should be done. Details. ("Riverside Park.")

Thursday, May 26, 1910

page

1. The terminal station of the Arkansas Valley Interurban Railway company is to be located at the corner of 1st and Water. The tract was purchased today from Herman Steinbuchel for \$40,000, or \$320 per front foot. It extends 125 feet on Water street and 140 feet on 1st street. The site is a portion of the Fred Stackman estate. Mrs. Steinbuchel was formerly Mrs. Stackman. It had been owned by her family for 28 years. ¶ Cars for use on the line between Wichita and Valley Center are expected to arrive early in July. Motormen and conductors are already being hired to begin work about August 1.

Friday, September 2, 1921

page

11. Report of death this morning of Herman J. Steinbuchel, age 77, pioneer insurance and real estate dealer, at his home, 1017 Franklin Avenue. Came to U.S. from Coln (sic), Germany and lived in New Jersey two years before coming to Wichita. Opened an insurance and real estate office here in 1876. Married Mrs. Marie Stackman 27 years ago. Survived also by two sons, Herman, Jr. and Max, a daughter, Mrs. W. B. Wilson, a step-daughter Mrs. Bertha Stackman Gouldner, three sisters and two brothers (named), all of Wichita. Photograph.

Sunday, October 21, 1923

page

- B-6. Article about plans of Stackman Building and Investment Company to plat and sell about 50 acres in Central Riverside that are a part of the old Frederick Stackman farm. Details. Owners are Mrs. Marie Steinbuchel, 1905 North Main, Mrs. Bertha Stackman Gouldner and Dr. R. M. Gouldner, 1905 Park Place, Fred Stackman, 937 Spaulding, and H. J. Steinbuchel, 1919 Park Place.

Wednesday, November 28, 1923

page

2. Max Steinbuchel has filed suit to break the will of his father, late Herman Steinbuchel, who died September 14, 1921. Original will left estate to wife and two sons and one daughter, but a later codicil added a step-daughter, Mrs. Bertha Stackman Gouldner and a step-son, Fred Stackman, to the devisees, and is being contested. Estate is worth approximately \$40,000.

Friday, September 3, 1926

page

1. The city today purchased land in the West Riverside district as the site for a municipal art museum. It comprises a part of the Stackman tract at the intersection of Sim Park Drive and River Boulevard and fronts the lagoon which the Little River forms as it circles the Municipal bathing beach. Mrs. Marie Steinbuchel, administrator of the estate, sold the tract (five acres) for \$16,500, which is below the market price, and then ceded 2.15 acres more, giving the city a total tract of 7.15 acres, thought to be worth \$25,000, for the \$16,500. The Stackman estate, of which this is a part, was established by Frederick P. Stackman in 1873, and in 1881 he bought a farm of 130 acres in what is now Riverside addition. His widow, Mrs. Marie Steinbuchel, still lives in the original homestead, 705 Faulkner.

Sunday, August 23, 1931

page

- B-10. Photograph of the new Stackman Bridge across Little Arkansas River on West Central, which will be opened by October 1. Article with details. Contract let October 1, 1930. Bridge is 425 feet long and 56 feet wide, with 40 foot roadway. It was designed by P. L. Brockway, city engineer. Cost approximately \$103,000.

Thursday, October 1, 1931

page

14 Opening of the Stackman Bridge over Little Arkansas River on Central Avenue is to be held at 4:00 p.m. today. Fred Stackman came to Wichita in 1872 and settled on a homestead which land is now part of Riverside Park and the residential section westward. His death occurred 36 years ago. His widow is now Mrs. Marie Steinbuchel.

SELECTIONS FROM DR. EDWARD N. TIHEN'S NOTES FROM WICHITA NEWSPAPERS
COPY PROVIDED BY SPECIAL COLLECTIONS, WICHITA STATE UNIVERSITY

Please note: The "Tihen Notes," as we call them, provide an excellent starting point for further research. They present brief synopses of newspaper articles, identify the newspaper -- Eagle or Beacon -- in which the stories first appeared, and give exact references to the pages on which the articles are found. Microfilmed copies of these newspapers are available at the Wichita State University Library, the Wichita Public Library, or by interlibrary loan from the Kansas State Historical Society.

Keywords: Stackman

Wichita Eagle-Beacon

Sunday, February 25, 1968

page

- 1D. Target date is June 15 for completion of the first units of Stackman-Gouldner Riviera Apartments at 705-715 Stackman Drive. Structural work is about 33 percent complete on the French Provincial style buildings. To have 48 apartment units. The apartments are located on the old Frederick P. Stackman homesite.

Sunday, October 20, 1968

page

- 1F. Open house will be held next Saturday and Sunday at the new Stackman-Gouldner Riviera Apartments, 705 Stackman Drive. Details. Architects are Feagins and Kirsch. The old Stackman house on the site was razed last year. Photo.

Saturday, February 28, 1970

page

1. Report of death yesterday at her home, of Mrs. Rene (Bertha) Gouldner, 82, of 139 Courtleigh, daughter of a pioneer Wichita family. Born Bertha Stackman on August 3, 1888, at her parents' home in Riverside. Attended the Pro-Cathedral elementary school at 2nd and St. Francis. Graduated from Mount Carmel Academy. Spent two and one-half years studying pipe organ in Strasbourg, France. Met her husband in France and they were married September 4, 1913 in Wichita. Survived by husband, a son, Dr. Rene R. Gouldner, a dentist, and a sister, Mrs. Elizabeth Guldner, both of Wichita, and three grandchildren. Photo. Entombment in Mission Chapel Mausoleum.

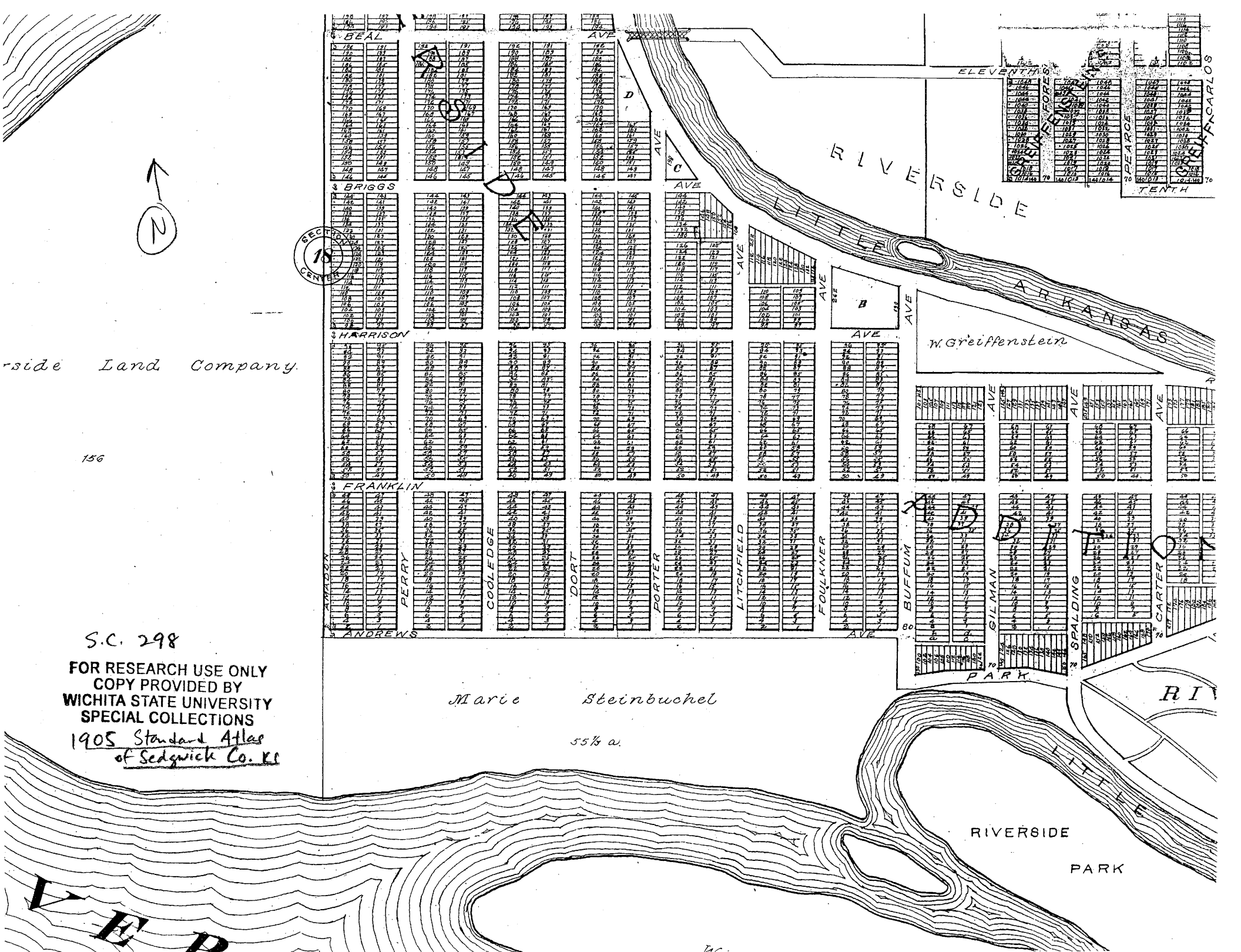

SEC 18
CENTER

side Land Company.

156

S.C. 298

FOR RESEARCH USE ONLY
COPY PROVIDED BY
WICHITA STATE UNIVERSITY
SPECIAL COLLECTIONS
1905 Standard Atlas
of Sedgewick Co. KS

Marie Steinbuchel

55 1/2 a.

W E B

RIVERSIDE
PARK

124 125 126 127 128 129 130 131 132 133 134 135 136 137 138 139 140 141 142 143 144 145 146 147 148 149 150 151 152 153 154 155 156 157 158 159 160 161 162 163 164 165 166 167 168 169 170 171 172 173 174 175 176 177 178 179 180 181 182 183 184 185 186 187 188 189 190 191 192 193 194 195 196 197 198 199 200	181 182 183 184 185 186 187 188 189 190 191 192 193 194 195 196 197 198 199 200 201 202 203 204 205 206 207 208 209 210 211 212 213 214 215 216 217 218 219 220 221 222 223 224 225 226 227 228 229 230 231 232 233 234 235 236 237 238 239 240 241 242 243 244 245 246 247 248 249 250 251 252 253 254 255 256 257 258 259 260 261 262 263 264 265 266 267 268 269 270 271 272 273 274 275 276 277 278 279 280 281 282 283 284 285 286 287 288 289 290 291 292 293 294 295 296 297 298 299 300	281 282 283 284 285 286 287 288 289 290 291 292 293 294 295 296 297 298 299 300 301 302 303 304 305 306 307 308 309 310 311 312 313 314 315 316 317 318 319 320 321 322 323 324 325 326 327 328 329 330 331 332 333 334 335 336 337 338 339 340 341 342 343 344 345 346 347 348 349 350 351 352 353 354 355 356 357 358 359 360 361 362 363 364 365 366 367 368 369 370 371 372 373 374 375 376 377 378 379 380 381 382 383 384 385 386 387 388 389 390 391 392 393 394 395 396 397 398 399 400	401 402 403 404 405 406 407 408 409 410 411 412 413 414 415 416 417 418 419 420 421 422 423 424 425 426 427 428 429 430 431 432 433 434 435 436 437 438 439 440 441 442 443 444 445 446 447 448 449 450 451 452 453 454 455 456 457 458 459 460 461 462 463 464 465 466 467 468 469 470 471 472 473 474 475 476 477 478 479 480 481 482 483 484 485 486 487 488 489 490 491 492 493 494 495 496 497 498 499 500	501 502 503 504 505 506 507 508 509 510 511 512 513 514 515 516 517 518 519 520 521 522 523 524 525 526 527 528 529 530 531 532 533 534 535 536 537 538 539 540 541 542 543 544 545 546 547 548 549 550 551 552 553 554 555 556 557 558 559 560 561 562 563 564 565 566 567 568 569 570 571 572 573 574 575 576 577 578 579 580 581 582 583 584 585 586 587 588 589 590 591 592 593 594 595 596 597 598 599 600	601 602 603 604 605 606 607 608 609 610 611 612 613 614 615 616 617 618 619 620 621 622 623 624 625 626 627 628 629 630 631 632 633 634 635 636 637 638 639 640 641 642 643 644 645 646 647 648 649 650 651 652 653 654 655 656 657 658 659 660 661 662 663 664 665 666 667 668 669 670 671 672 673 674 675 676 677 678 679 680 681 682 683 684 685 686 687 688 689 690 691 692 693 694 695 696 697 698 699 700	701 702 703 704 705 706 707 708 709 710 711 712 713 714 715 716 717 718 719 720 721 722 723 724 725 726 727 728 729 730 731 732 733 734 735 736 737 738 739 740 741 742 743 744 745 746 747 748 749 750 751 752 753 754 755 756 757 758 759 760 761 762 763 764 765 766 767 768 769 770 771 772 773 774 775 776 777 778 779 780 781 782 783 784 785 786 787 788 789 790 791 792 793 794 795 796 797 798 799 800	801 802 803 804 805 806 807 808 809 810 811 812 813 814 815 816 817 818 819 820 821 822 823 824 825 826 827 828 829 830 831 832 833 834 835 836 837 838 839 840 841 842 843 844 845 846 847 848 849 850 851 852 853 854 855 856 857 858 859 860 861 862 863 864 865 866 867 868 869 870 871 872 873 874 875 876 877 878 879 880 881 882 883 884 885 886 887 888 889 890 891 892 893 894 895 896 897 898 899 900	901 902 903 904 905 906 907 908 909 910 911 912 913 914 915 916 917 918 919 920 921 922 923 924 925 926 927 928 929 930 931 932 933 934 935 936 937 938 939 940 941 942 943 944 945 946 947 948 949 950 951 952 953 954 955 956 957 958 959 960 961 962 963 964 965 966 967 968 969 970 971 972 973 974 975 976 977 978 979 980 981 982 983 984 985 986 987 988 989 990 991 992 993 994 995 996 997 998 999 1000
---	--	--	--	--	--	--	--	---

W. Greiffenstein

Marie Steinbuchel

55 1/2 a.

RIVERSIDE
PARK