

# TOWNSHIP 27 SOUTH RANGE 1 EAST.

OF THE 6<sup>TH</sup> PRINCIPAL MERIDIAN.  
SCALE: 2 INCHES TO 1 MILE.

*Meridian*

*Sence*

*Bethany Lawrence*

*Hypocrite*

*Hillside*

*Oliver*

*Woodlawn*

*29<sup>th</sup> St*

*21<sup>st</sup>*

*Central*

*Douglas*

*Kelly*

*HARRY*

*MT View*

*Pawnee*

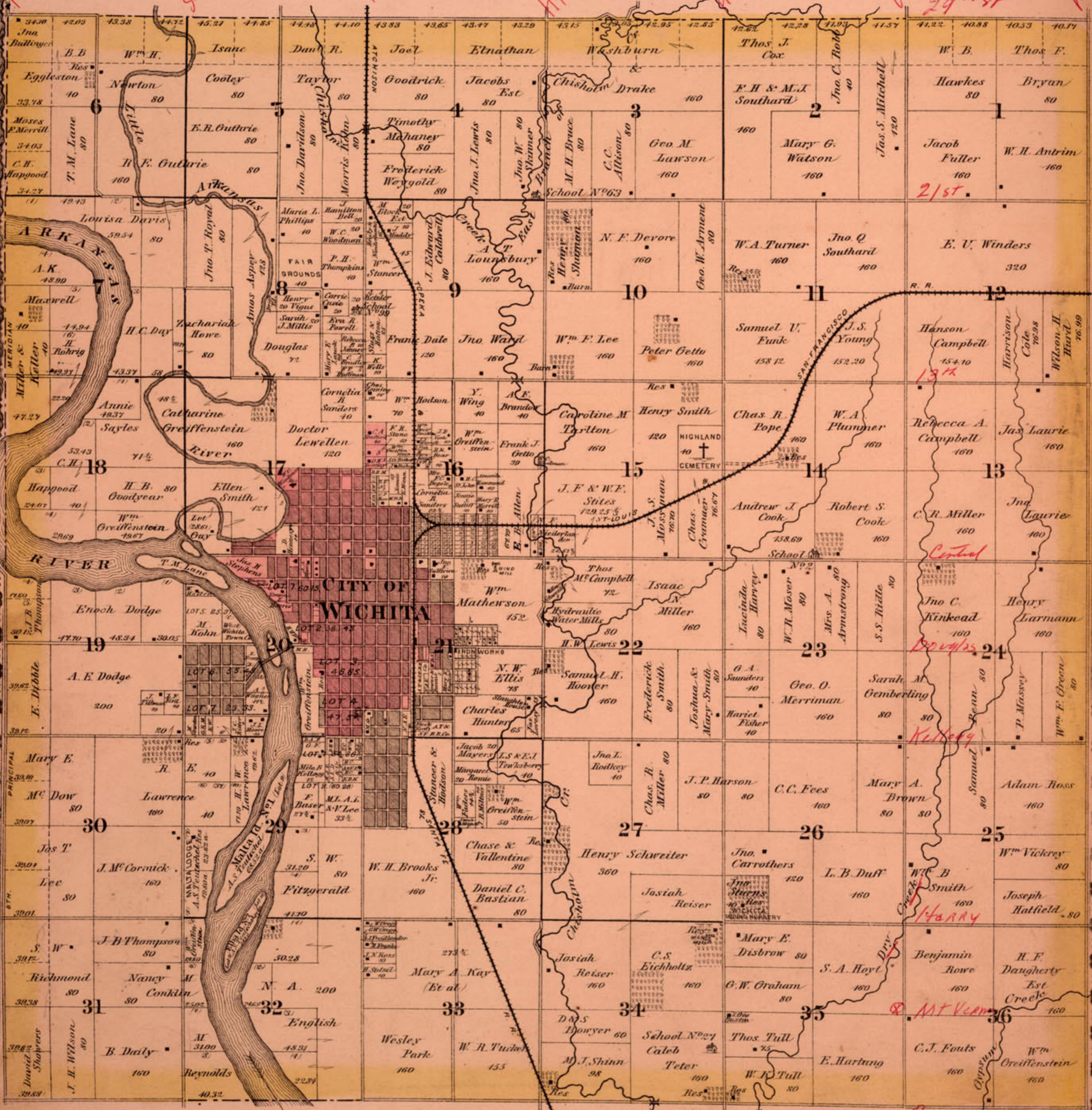

**CITY OF WICHITA**

Map showing land parcels with owner names and acreage. Owners include: B.B. Eggleston, Wm H. Newton, Isaac Cooley, Dan R. Taylor, Joel Goodrick, Elnathan Jacobs Est, Washburn Drake, Thos J. Cox, W.B. Hawkes, Thos F. Bryan, Moses Merrill, T.M. Lane, E.R. Guthrie, Timothy Mahaney, Frederick Weygold, Geo M. Lawson, Mary G. Watson, Jacob Fuller, W.H. Antrim, C.H. Haggood, Louisa Davis, Maria L. Phillips, J. Estward Caldwell, N.F. Devore, W.A. Turner, Jno Q. Southard, E.U. Winders, H.C. Day, Zachariah Howe, Douglas, Erank Dale, Jno Ward, Wm F. Lee, Peter Getto, Samuel V. Funk, J.S. Young, Hanson Campbell, H.C. Greiffenstein, Doctor Lewellen, Wm. Greiffenstein, Frank J. Getto, Caroline M. Tarlton, Henry Smith, Chas. R. Pope, W.A. Plummer, Rebecca A. Campbell, Jas. Laurie, H.B. Oodyear, Ellen Smith, J.F. & W.E. Stiles, Andrew J. Cook, Robert S. Cook, C.R. Miller, Jno Laurie, T.M. Lane, Enoch Dodge, M. Kohn, Wm. Mathewson, Thos Mc Campbell, Isaac Miller, Tracinda Harvey, W.R. Moser, Mrs. A. Armstrong, S.S. Titzle, Jno C. Kinkead, Henry Larmann, A.E. Dodge, F. Dittble, Mary E. Dow, Lawrence Fitzgerald, S.W. Brooks Jr., Chase & Valentine, Daniel C. Bastian, Samuel L.H. Hoover, Frederick Smith, Joshua & Mary Smith, Harriet Fisher, Geo. O. Merriman, Sarah M. Gemberling, Jno. Carrothers, L.B. Duff, Wm. Vickrey, J.M. Cormick, J.B. Thompson, J.W. Richmond, Nancy Conklin, Mary A. Kay (Et al), Jostiah Reiser, C.S. Eichholtz, Mary E. Disbrow, S.A. Hoyt, Benjamin Rowe, H.F. Daugherty, J.H. Wilson, B. Dally, Reynolds, Wesley Park, W.R. Tucker, D.S. Dwyer, M.J. Shinn, School N°27, Thos. Tull, W.K. Tull, E. Hartung, C.J. Fouts, Wm. Greiffenstein.