

TOWNSHIP N^o 29 SOUTH RANGE N^o 1 EAST OF THE 6th PRINCIPAL MERIDIAN KAN

G I F E d D c C b B a A

Meanders of

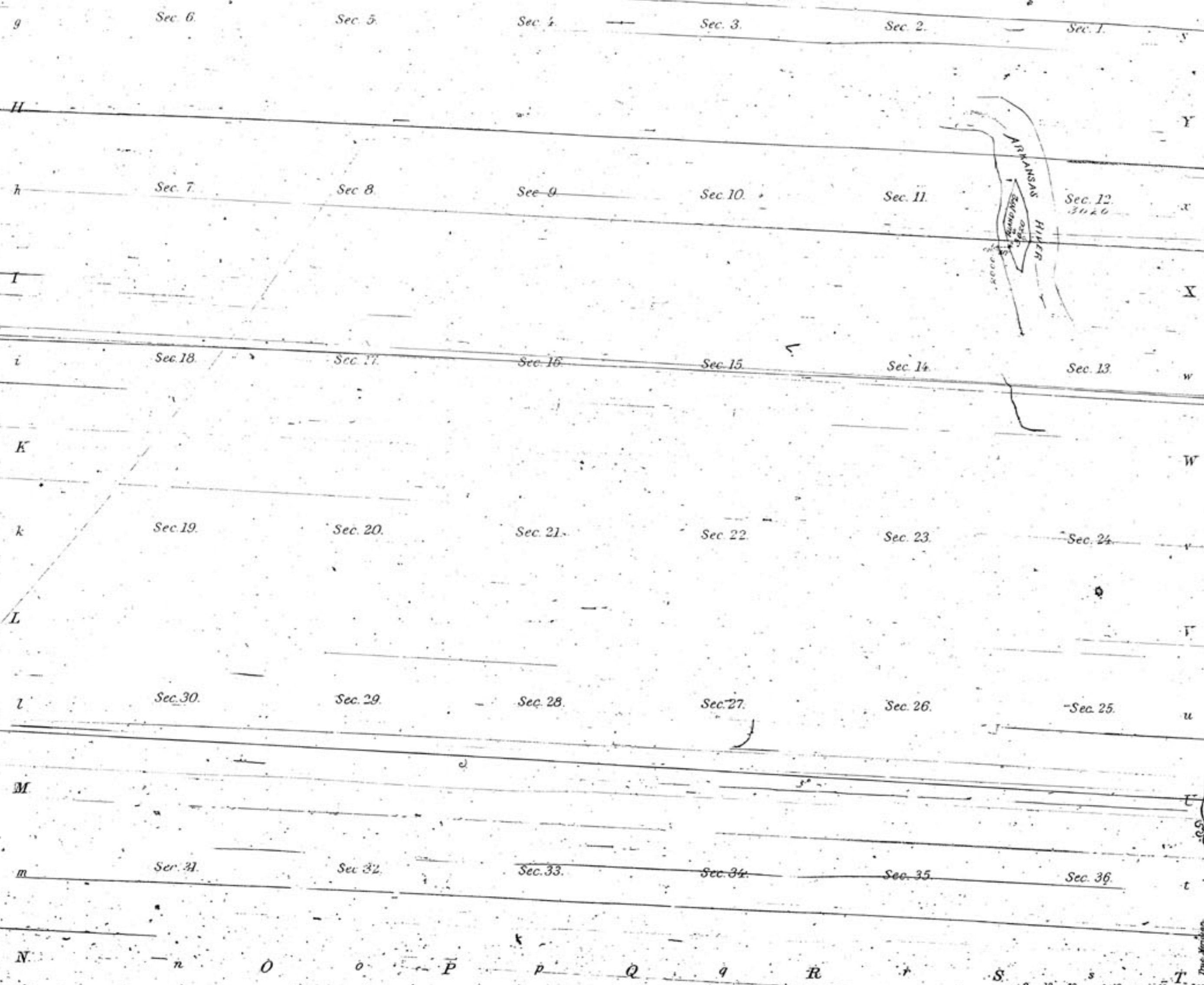

Section	Notes
1	
2	
3	
4	
5	
6	
7	
8	
9	
10	
11	
12	3126
13	
14	
15	
16	
17	
18	
19	
20	
21	
22	
23	
24	
25	
26	
27	
28	
29	
30	
31	
32	
33	
34	
35	
36	

The Survey General's Office
 Lawrence, Kansas, March 1, 1876
 I certify that J. K. Lloyd did deposit
 for the survey of the island herewith sub-
 scribed fifty dollars (\$50) and for other
 work twenty dollars (\$20)
 C. W. Babcock
 Survey General

Total number of Acres 30.20

Surveys Designated	By Whom Surveyed	Date of Contract	Amount of Surveys	When Surveyed
Township lines			M. C. A.	
Subdivisions	L. A. Thrasher	Dec 7, 1875		Jan 29, 1876

The above Map of Township N^o 29 South of Range N^o 1 East of 6th Principal Meridian KAN is strictly conformable to the field notes of the survey thereof on file in this Office which have been examined and approved.
 Survey General's Office
 Lawrence, Kas. March 1, 1876
 C. W. Babcock
 Sur. Gen.